

# Manual

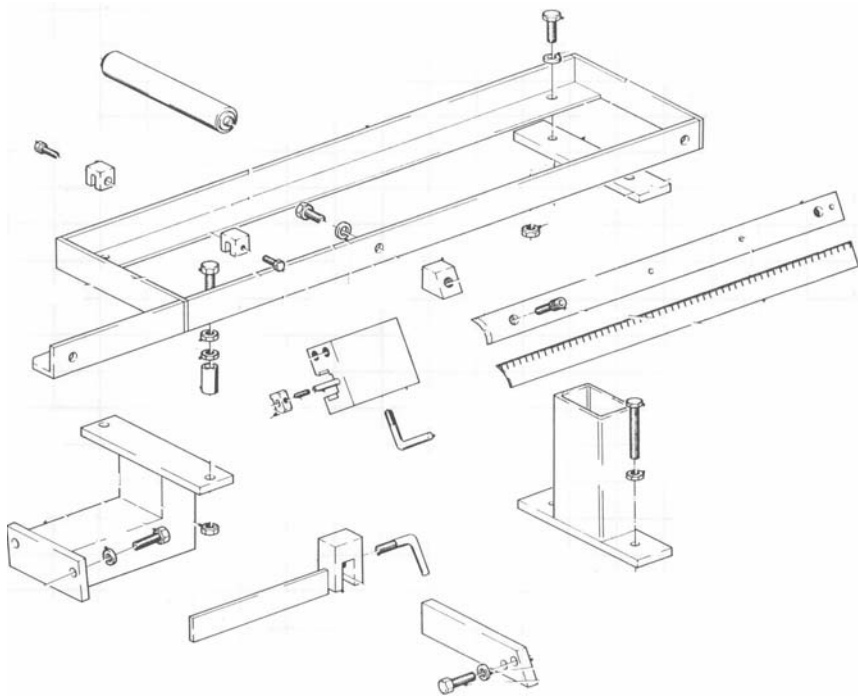

## roller tracks

without & with  
length stop and graduation

to be used with  
Bewo circular sawing machines

# 1 Table of contents

	Bladzijde
1	<i>Table of contents</i> ..... 2
2	<i>Dear Customer</i> ..... 2
3	<i>Survey and skets of dimensions</i> ..... 2
4	<i>Installation and mounting</i> ..... 3
5	<i>Parts lists</i> ..... ever since page 4

# 2 Dear Customer

We at **Machinefabriek BEWO** take great pride in the manufacture of the CPO sawing machines and accessories like these roller tracks and are confident that you will enjoy efficient productive Service for many years.

With kind regards

Machinefabriek Bewo b.v.  
 Postbus 5059  
 5004 EB Tilburg  
 The Netherlands

[www.bewo.nl](http://www.bewo.nl)

# 3 Survey and skets of dimensions

Type	Working height H in mm
CPO 250	920
CPO 315	955
CPO 350	955

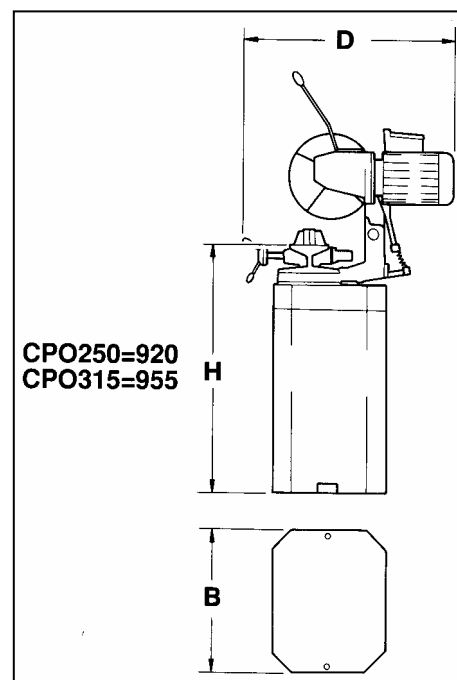

Fig. 1



## 4 Installation and mounting

1. Unpack the roller track.
2. Determine where the roller track will be placed. Left or right at the machine (Left and right seen from the position when you are working with the machine).
3. Mount the support pos. 844 at your machine.
  - a. In case of that you mount this track at a CPO250 sawing machine, place than the support pos 844 as HIGH as possible in the slit holes. DO NOT USE the 2 spacer bushes pos. 845.
  - b. In case of that you mount this track at a CPO315 sawing machine, place than the support pos 844 as LOW as possible in the slit holes. DO USE the 2 spacer bushes pos. 845.
4. Mount 1 or more (dependently from the length of your track) adjustable foots at the feed track.
5. Mount the feed track at the support. Take note with point 3a and 3b, yes or no spacer bushes.
6. Adjust the track on the right working height and align this out with the material vice.
7. Mount the brackets, pos. 827, 2 per roll and mount a roll. Note: Close to the machine the rolls are to be close to each other, balance of trade maximum spacing of rolls.
8. If this is a track WITH LENGTH STOP, mount the sliding block /length stop.
9. Adjust the ruler reader head pos. 841 as follows:
  - a. Mount the aux. stop strip, pos 843.
  - b. Pull down the saw head WITHOUT turning motor.
  - c. Slide the length stop block WITH aux. Stop against the NOT ROTATING saw blade.
  - d. Adjust the ruler reader head on the 0 from the scale division.
  - e. Fix this ruler reader head with the socket head screw pos. 840.

## 5 Parts lists

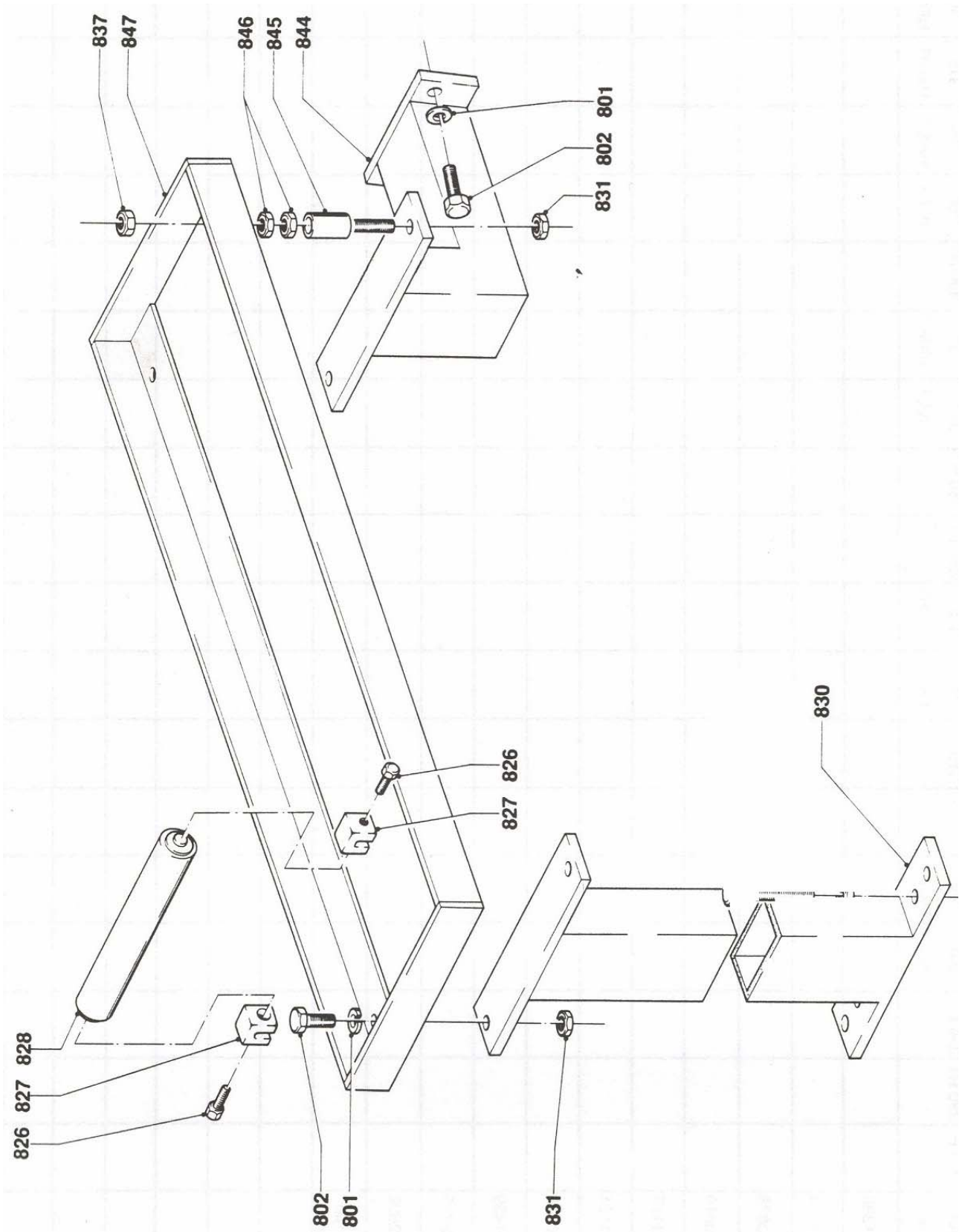



<b>Roller track without length stop</b>			Quantity per track at length:					
Pos.nr.	Description	Art.nr.	1 m	2 m	3 m	4 m	5 m	6 m
801	Washer ring 10	44.2313	6	6	8	8	10	12
802	Screw M10x30	44.1385	4	4	6	6	8	10
826	Screw M6x8	44.1330	6	8	10	12	14	16
827	Bracket	50.8809	6	8	10	12	14	16
828	Roll	50.1013	3	4	5	6	7	8
830	Adjustable foot	65.2160	1	1	2	2	3	4
831	Nut M10	44.2008	4	4	6	6	8	10
837	Screw M10x80	44.1395	2	2	2	2	2	2
844	Support	60.3942	1	1	1	1	1	1
845 **	Spacer bush	50.3715	2	2	2	2	2	2
847 ***	Feed track 1 m	60.0680	1					
847 ***	Feed track 2 m	60.0856		1				
847 ***	Feed track 3 m	60.0344			1			
847 ***	Feed track 4 m	60.1833				1		
847 ***	Feed track 5 m	60.1834					1	
847 ***	Feed track 6 m	60.3343						1

\*\* ) Do NOT use these spacer bushes in case this track will be attached to an circular sawing machine, model CPO 250 LT or CPO 250 HT.

\*\*\* ) Length dependent.

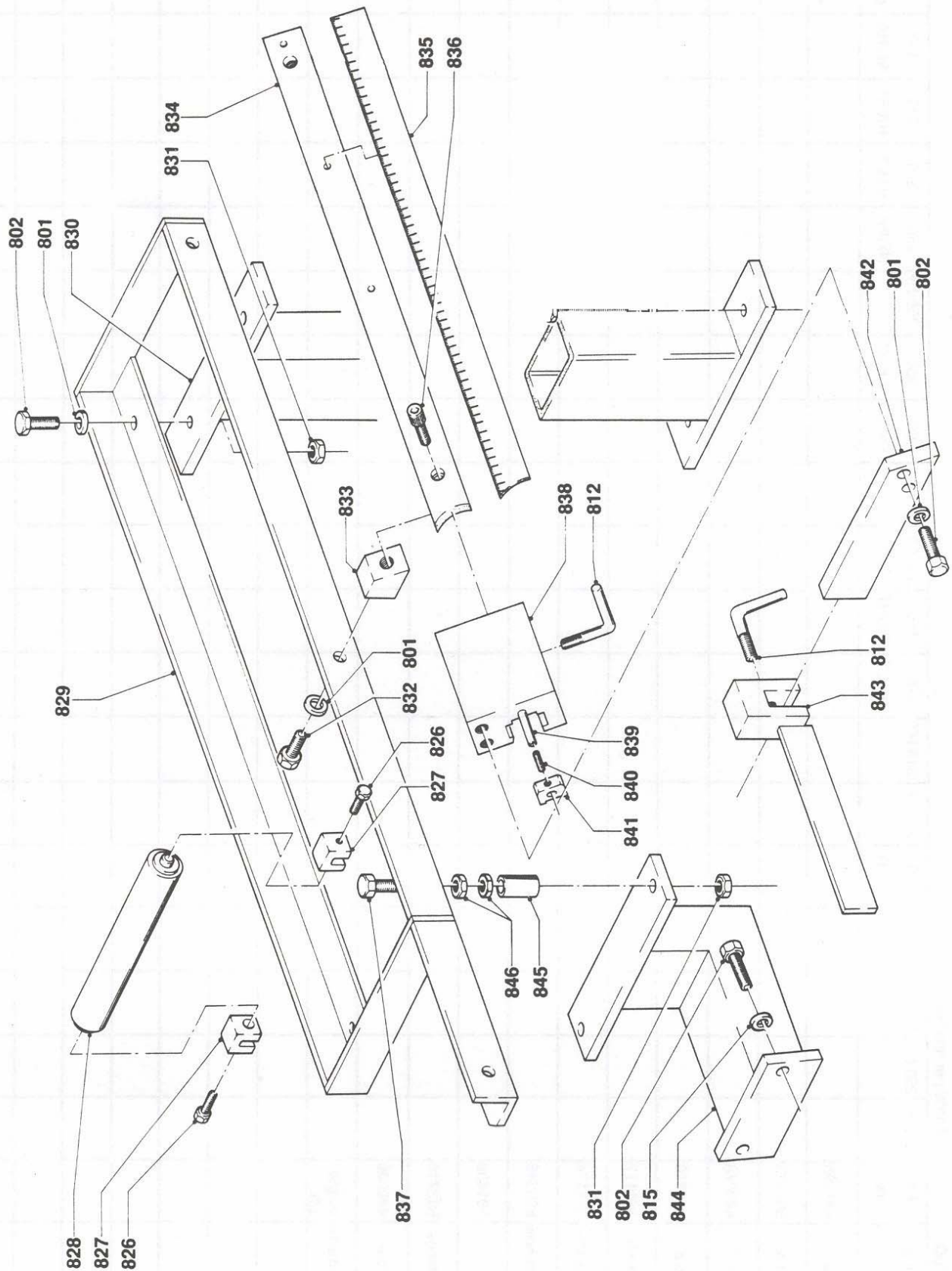



Roller track with length stop RIGHT *			Quantity per roller track at length:					
Pos.nr.	Description	Art.nr.	1 m	2 m	3 m	4 m	5 m	6 m
801	Washer ring 10	44.2313	10	12	15	17	21	25
802	Screw M10x30	44.1385	5	5	7	7	9	11
812	Handle	50.1010	2	2	2	2	2	2
826	Screw M6x8	44.1330	6	8	10	12	14	16
827	Bracket	50.8809	6	8	10	12	14	16
828	Roll	50.1013	3	4	5	6	7	8
830	Adjustable foot	65.2160	1	1	2	2	3	4
831	Nut M10	44.2008	4	4	6	6	8	10
832	Screw M10x16	44.1381	3	5	7	9	11	13
833	Supporting block	50.1170	3	5	7	9	11	13
834***	Strip 1 metre	50.1171	1					
834***	Strip 2 metre	50.1285		1				
834***	Strip 3 metre	50.1288			1			
834***	Strip 4 metre	50.1378				1		
834***	Strip 5 metre	50.7184					1	
834***	Strip 6 metre	50.7185						1
835 ***	Ruler flexible yellow 0-3 m	48.6680	1	1	1			
835 ***	Ruler alu. 0 - 3 metre right	50.4062				1	1	1
835 ***	Ruler alu. 3 - 4 metre right	50.4085				1		
835 ***	Ruler alu. 3 - 5 metre right	50.2352					1	
835 ***	Ruler alu. 3 - 6 metre right	50.2354						1
837	Screw M10x80	44.1395	2	2	2	2	2	2
838	Sliding block	50.5575	1	1	1	1	1	1
839	Dowel pin 8x50	44.3078	1	1	1	1	1	1
840	Adjustable screw MSP	44.0810	1	1	1	1	1	1
841	Ruler reader head for flex.Yellow ruler	50.1177	1	1	1			
	Ruler reader head for aluminium ruler	50.7183				1	1	1
842	Stop strip	50.1174	1	1	1	1	1	1
843	Aux. Stop strip	60.0348	1	1	1	1	1	1
844	Support	60.3942	1	1	1	1	1	1
845	Spacer bush	50.3715	2	2	2	2	2	2
847 ***	Feed track 1 m right	60.0347	1					
847 ***	Feed track 2 m right	60.0405		1				
847 ***	Feed track 3 m right	60.0406			1			
847 ***	Feed track 4 m right	60.0437				1		
847 ***	Feed track 5 m right	60.1442					1	
847 ***	Feed track 6 m right	60.1443						1

- \*) Roller track WITH length stop and ruler RIGHT must be seen from the position when you are working with the sawing machine.  
The ruler from a 1 metre track is 1,22 metre. From a 2 metre track is 2,22 metre etc.
- \*\* ) Do NOT use these spacer bushes in case this track will be attached to an circular sawing machine, model CPO 250 LT or CPO 250 HT.
- \*\*\* ) Length dependent.

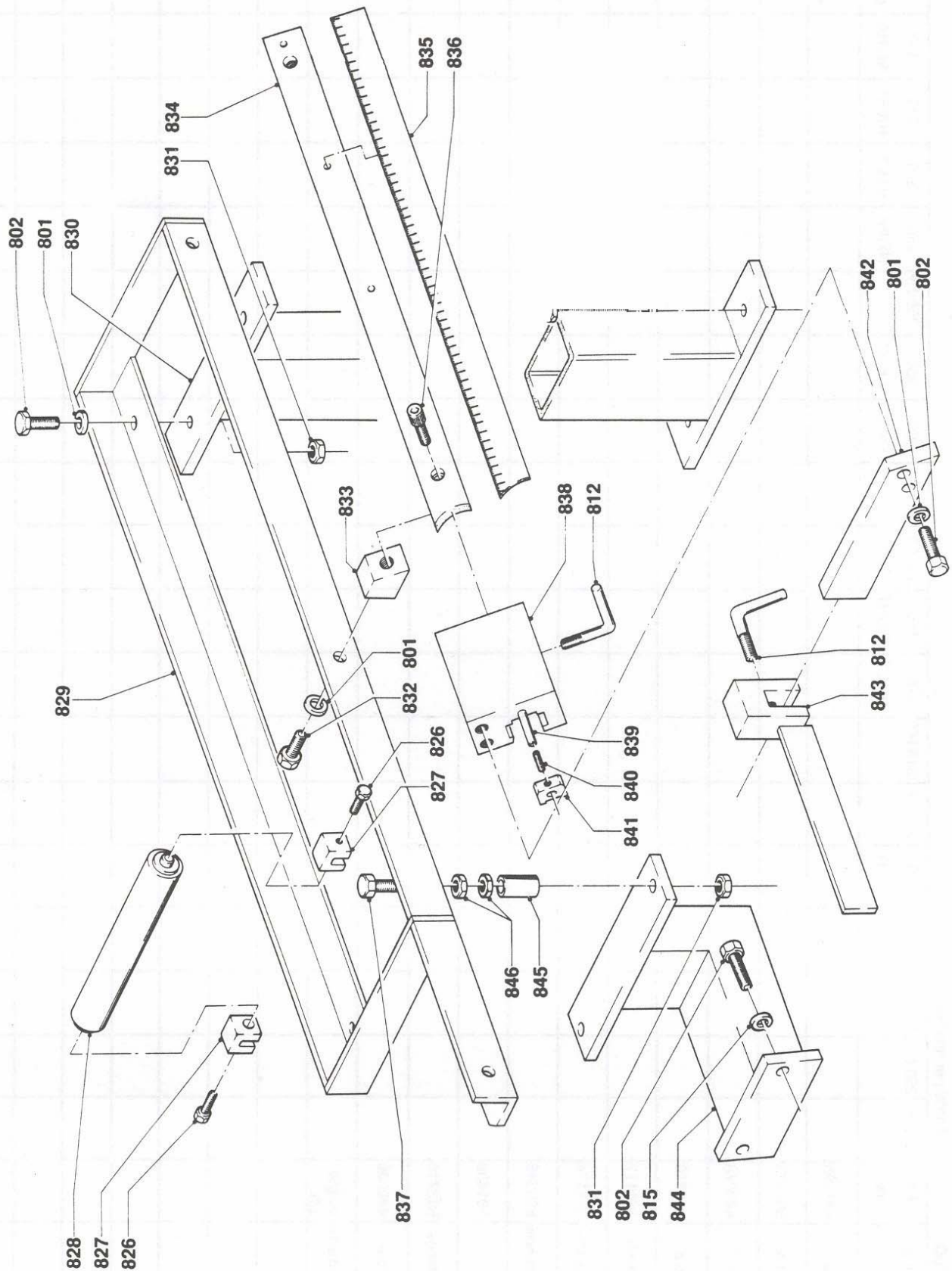



Roller track <b>with</b> length stop <b>LEFT</b> *			Quantity per roller track at length:					
Pos.nr.	Description	Art.nr.	1 m	2 m	3 m	4 m	5 m	6 m
801	Washer ring 10	44.2313	10	12	15	17	21	25
802	Screw M10x30	44.1385	5	5	7	7	9	11
812	Handle	50.1010	2	2	2	2	2	2
826	Screw M6x8	44.1330	6	8	10	12	14	16
827	Bracket	50.8809	6	8	10	12	14	16
828	Roll	50.1013	3	4	5	6	7	8
830	Adjustable foot	65.2160	1	1	2	2	3	4
831	Nut M10	44.2008	4	4	6	6	8	10
832	Screw M10x16	44.1381	3	5	7	9	11	13
833	Supporting block	50.1170	3	5	7	9	11	13
834 ***	Strip 1 metre	50.1171	1					
834 ***	Strip 2 metre	50.1285		1				
834 ***	Strip 3 metre	50.1288			1			
834 ***	Strip 4 metre	50.1378				1		
834 ***	Strip 5 metre	50.7184					1	
834 ***	Strip 6 metre	50.7185						1
835 ***	Ruler alu. 0 - 1 metre left	50.2345	1					
835 ***	Ruler alu. 0 - 2 metre left	50.2346		1				
835 ***	Ruler alu. 0 - 3 metre left	50.2347			1	1	1	1
835 ***	Ruler alu. 3 - 4 metre left	50.4086				1		
835 ***	Ruler alu. 3 - 5 metre left	50.2353					1	
835 ***	Ruler alu. 3 - 6 metre left	50.2355						1
837	Screw M10x80	44.1395	2	2	2	2	2	2
838	Sliding block	50.5575	1	1	1	1	1	1
839	Dowel pin 8x50	44.3078	1	1	1	1	1	1
840	Adjustable screw MSP	44.0810	1	1	1	1	1	1
841	Ruler reader head for aluminium ruler	50.7183	1	1	1	1	1	1
842	Stop strip	50.1174	1	1	1	1	1	1
843	Aux. Stop strip	60.0348	1	1	1	1	1	1
844	Support	60.3942	1	1	1	1	1	1
845	Spacer bush	50.3715	2	2	2	2	2	2
847 ***	Feed track 1 m left	60.0861	1					
847 ***	Feed track 2 m left	60.0862		1				
847 ***	Feed track 3 m left	60.0863			1			
847 ***	Feed track 4 m left	60.0864				1		
847 ***	Feed track 5 m left	60.3964					1	
847 ***	Feed track 6 m left	60.3963						1

- \*) Roller track WITH length stop and ruler LEFT must be seen from the position when you are working with the sawing machine.  
The ruler from a 1 metre track is 1,22 metre. From a 2 metre track is 2,22 metre etc.
- \*\* ) Do NOT use these spacer bushes in case this track will be attached to an circular sawing machine, model CPO 250 LT or CPO 250 HT.
- \*\*\* ) Length dependent.